

# Bloomerang

• A Free Project Sheet •  
• NOT FOR RESALE •

By Jane Shasky

Quilt Design by Heidi Pridemore



Quilt 1

Skill Level: Intermediate



Henry Glass & Co., Inc.



facebook

Finished Quilt Size: 62" x 80"  
(157.48 cm x 203.20 cm)

49 West 37th Street, New York, NY 10018

tel: 212-686-5194 fax: 212-532-3525

Toll Free: 800-294-9495

[www.henryglassfabrics.net](http://www.henryglassfabrics.net)

Please check our website for pattern updates before starting this project.



# BLOOMERANG

Quilt 1

Finished Quilt Size: 62" x 80"  
(157.48 cm x 203.20 cm)

## Fabrics in the Collection



Packed Lilac  
Multi – 954-56



Lilac Garden  
Multi – 955-05



Vine  
Green – 956-66



Tossed Lilac and Butterflies  
Green – 957-65



Packed Flowers  
Lavender – 958-55



Packed Flowers  
Periwinkle – 958-75



Small Tossed Lilac and Butterflies  
Multi – 959-05



Small Lilac Flower Tossed  
Lilac – 960-05

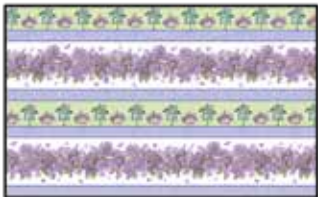

Border Stripe  
Multi – 961-57



3 Blocks Panel 24 in x 44 in  
Multi – 962P-05

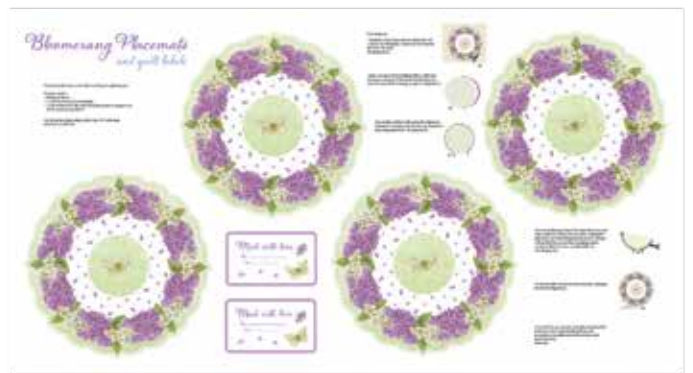

Placemats Panel 24 in x 44 in  
Multi – 963P-05

## Select Fabrics from Folio Basics



White on White  
7755-01



Lilac  
7755-05



Celery  
7755-06



Light Violet  
7755-56



Early Green  
7755-62

# BLOOMERANG

## Quilt 1

## Page 3

### Materials

1 panel	3 Blocks Panel 24 in x 44 in - Multi (A)	962P-05
$\frac{2}{3}$ yard (0.61 m)	Folio Basics - Lilac (B)	7755-05
2 $\frac{1}{2}$ yards (2.29 m)	Border Stripe - Multi (C)	961-57
$\frac{3}{8}$ yard (0.35 m)	Folio Basics - Celery (D)	7755-06
1 $\frac{1}{8}$ yards (1.03 m)	Folio Basics - White on White (E)	7755-01
$\frac{1}{4}$ yard (0.23 m)	Packed Lilac - Multi (F)	954-56
$\frac{3}{8}$ yard (0.35 m)	Packed Flowers - Lavender (G)	958-55
$\frac{1}{2}$ yard (0.46 m)	Vine - Green (H)	956-66
1 yard (0.92 m)	Packed Flowers - Periwinkle (I)	958-75*
$\frac{1}{2}$ yard (0.46 m)	Small Lilac Flower Tossed - Lilac (J)	960-05
5 yards (4.58 m)	Lilac Garden - Multi (Backing)	955-05

\*Includes binding

### Cutting Instructions

*Please note: All strips are cut across the width of fabric (WOF) from selvage to selvage edge unless otherwise noted.*

#### From the 3 Blocks Panel 24 in x 44 in - Multi (A):

- Fussy cut (1) 23  $\frac{1}{2}$ " x 39  $\frac{1}{2}$ " rectangle, centered on the panel.

#### From the Folio Basics - Lilac (B), cut:

- (2) 2  $\frac{1}{2}$ " x 26  $\frac{1}{2}$ " WOF strips.
- (2) 2" x 39  $\frac{1}{2}$ " WOF strips.
- (4) 1  $\frac{1}{2}$ " x WOF strips. Sew the strips together end to end with diagonal seams and cut (2) 1  $\frac{1}{2}$ " x 68  $\frac{1}{2}$ " strips.
- (3) 1  $\frac{1}{2}$ " x WOF strips. Sew the strips together end to end with diagonal seams and cut (2) 1  $\frac{1}{2}$ " x 52  $\frac{1}{2}$ " strips.

#### From the Border Stripe - Multi (C), fussy cut:

- (2) 5  $\frac{1}{2}$ " x 84" Length of Fabric (LOF) strips, centered on the purple stripe.
- (2) 5  $\frac{1}{2}$ " x 66" LOF strips, centered on the purple stripe.
- (2) 5" x 55" LOF strips, centered on the green stripe.
- (2) 5" x 38" LOF strips, centered on the green stripe.

#### From the Folio Basics - Celery (D), cut:

- (2) 2" x 36  $\frac{1}{2}$ " WOF strips.
- (3) 1  $\frac{1}{2}$ " x WOF strips. Sew the strips together end to end with diagonal seams and cut (2) 1  $\frac{1}{2}$ " x 51  $\frac{1}{2}$ " strips.

#### From the Folio Basics - White on White (E), cut:

- (4) 4  $\frac{1}{4}$ " x WOF strips. Sub-cut (30) 4  $\frac{1}{4}$ " squares. Cut the squares across both diagonals to make (120) 4  $\frac{1}{4}$ " triangles.
- (2) 3  $\frac{1}{2}$ " x WOF strips. Sub-cut (16) 3  $\frac{1}{2}$ " squares.
- (4) 1  $\frac{1}{2}$ " x WOF strips. Sew the strips together end to end with diagonal seams and cut (2) 1  $\frac{1}{2}$ " x 66  $\frac{1}{2}$ " strips.
- (3) 1  $\frac{1}{2}$ " x WOF strips. Sew the strips together end to end with diagonal seams and cut (2) 1  $\frac{1}{2}$ " x 50  $\frac{1}{2}$ " strips.

#### From the Packed Lilac - Multi (F), cut:

- (1) 6  $\frac{1}{2}$ " x WOF strip. Sub-cut (4) 6  $\frac{1}{2}$ " squares.

#### From the Packed Flowers - Lavender (G), cut:

- (2) 4  $\frac{1}{4}$ " x WOF strips. Sub-cut (15) 4  $\frac{1}{4}$ " squares. Cut the squares across both diagonals to make (60) 4  $\frac{1}{4}$ " triangles.

#### From the Vine - Green (H), cut:

- (3) 3  $\frac{7}{8}$ " x WOF strips. Sub-cut (30) 3  $\frac{7}{8}$ " squares. Cut the squares across (1) diagonal to make (60) 3  $\frac{7}{8}$ " triangles.

#### From the Packed Flowers - Periwinkle (I), cut:

- (2) 4  $\frac{1}{4}$ " x WOF strips. Sub-cut (15) 4  $\frac{1}{4}$ " squares. Cut the squares across both diagonals to make (60) 4  $\frac{1}{4}$ " triangles.
- (8) 2  $\frac{1}{2}$ " x WOF strips for the binding.

#### From the Small Lilac Flower Tossed - Lilac (J), cut:

- (3) 3  $\frac{7}{8}$ " x WOF strips. Sub-cut (30) 3  $\frac{7}{8}$ " squares. Cut the squares across (1) diagonal to make (60) 3  $\frac{7}{8}$ " triangles.

#### From the Lilac Garden - Multi (Backing), cut:

- (2) 88" x WOF strips for the backing. Sew the strips together and trim to make the 70" x 88" back.

### Block Assembly

*Note: The arrows in figures represent the fabric print direction. Pay attention to the fabric and unit orientations when assembling the various components. Use a  $\frac{1}{4}$ " seam allowance with right sides together (RST) unless otherwise noted.*

1. Sew (1) 2" x 39  $\frac{1}{2}$ " Fabric B strip to each side of the 23  $\frac{1}{2}$ " x 39  $\frac{1}{2}$ " Fabric A rectangle. Sew (1) 2  $\frac{1}{2}$ " x 26  $\frac{1}{2}$ " Fabric B strip to the top and to the bottom of the Fabric A rectangle to make the Center Block (Fig. 1). **Trim the block to measure 25  $\frac{1}{2}$ " x 42  $\frac{1}{2}$ ".**

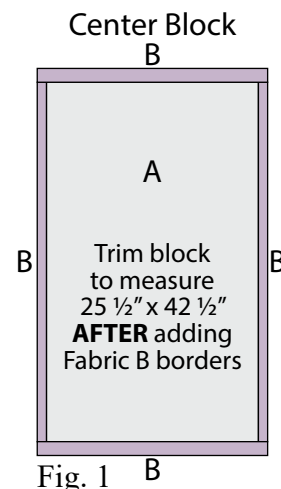

2. Sew (1) 4  $\frac{1}{4}$ " Fabric E triangle and (1) 4  $\frac{1}{4}$ " Fabric I triangle together along short sides. Sew (1) 3  $\frac{7}{8}$ " Fabric J triangle to the long side of the newly sewn triangle to make (1) 3  $\frac{1}{2}$ " Unit 1 square (Fig. 2). Repeat to make (60) Unit 1 squares total.

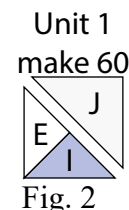

3. Repeat Step 2 and refer to Figure 3 for fabric identification, placement and orientation to make (60) Unit 2 squares.

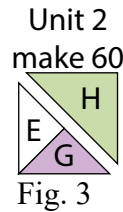

4. Refer to Figure 4 and sew together (4) Unit 1 squares into a 2 x 2 matrix to make (1) 6 1/2" Block One square. Repeat to make (15) Block One squares total.

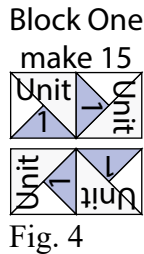

5. Refer to Figure 5 and sew together (4) Unit 2 squares into a 2 x 2 matrix to make (1) 6 1/2" Block Two square. Repeat to make (15) Block Two squares total.

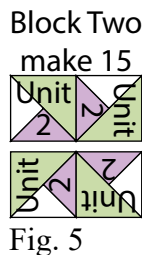

6. Place (1) 3 1/2" Fabric E square on the top left corner of (1) 6 1/2" Fabric F square, right sides together (Fig. 6). Sew across the diagonal of the smaller square from the upper right corner to the lower left corner (Fig. 6). Flip open the triangle formed and press. Trim away the excess fabric from behind the triangle 1/4" away from the sewn seam (Fig. 7).

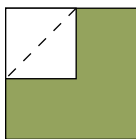

Fig. 6

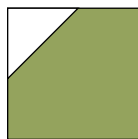

Fig. 7

7. Follow Figure 8 for the seam direction to add a 3 1/2" Fabric E square to each of the remaining corners of the 6 1/2" Fabric F square to make (1) Block Three square (Fig. 9).

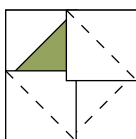
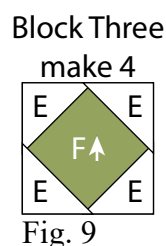
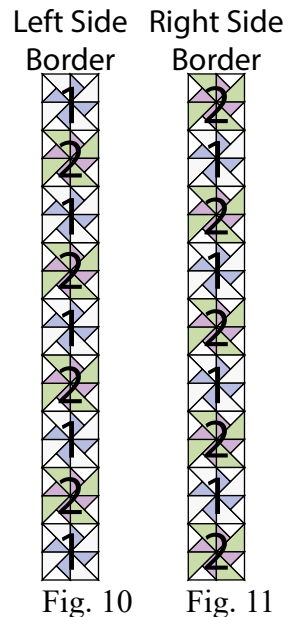

Fig. 8



9. Sew together (5) Block One squares and (4) Block Two squares, alternating them from top to bottom, to make the Left Side Border (Fig. 10).



10. Sew together (5) Block Two squares and (4) Block One squares, alternating them from top to bottom, to make the Right Side Border (Fig. 11).

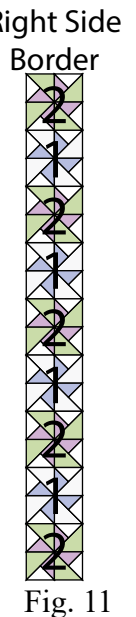

11. Sew together (3) Block Two squares and (3) Block One squares alternating them from left to right. Sew (1) Block Three square to each end of the newly sewn strip to make the Top Border (Fig. 12). Repeat to make the Bottom Border.

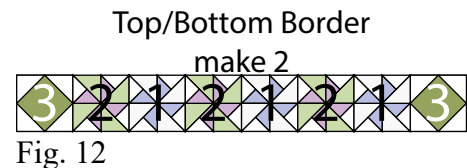

### Quilt Top Assembly

*(Follow the Quilt Layout while assembling the quilt top.)*

12. Center (1) 5" x 55" Fabric C strip on (1) side of the Center Block and pin in place. Start sewing the strip a 1/4" from the top edge of the block and stop a 1/4" from the bottom edge. **DO NOT TRIM THE EXCESS.** Repeat with the opposite side.

13. Repeat Step 12 to sew (1) 5" x 38" Fabric C strip to the top and to the bottom of the Center Block, making sure to stop and start 1/4" away from each end of the block. To miter each corner, fold the Center Block on a diagonal, wrong side together. This should line up the strips from adjacent sides (Fig. 13).

14. Starting at the sewn seam (represented by the arrow in Figure 13), draw a 45-degree line to the edge of the fabric. Sew on the drawn line. Trim the excess fabric leaving a 1/4" seam. Repeat this step with the remaining corners.

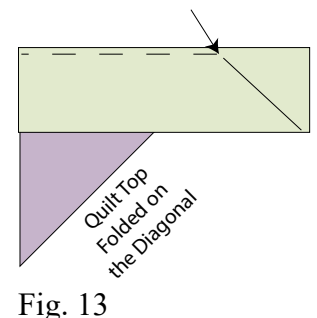

# BLOOMERANG

# Page 5

15. Sew (1) 1 ½" x 51 ½" Fabric D strip to each side of the Center Block. Sew (1) 2" x 36 ½" Fabric D strip to the top and to the bottom of the Center Block.

16. Sew the Left Side Border and Right Side Border to the left and to the right sides of the Center Block.

17. Sew the Top Border and the Bottom Border to the top and to the bottom of the Center Block.

18. Sew (1) 1 ½" x 66 ½" Fabric E strip to each side of the Center Block. Sew (1) 1 ½" x 50 ½" Fabric E strip to the top and to the bottom of the Center Block.

19. Sew (1) 1 ½" x 68 ½" Fabric B strip to each side of the Center Block. Sew (1) 1 ½" x 52 ½" Fabric B strip to the top and to the bottom of the Center Block.

20. Center (1) 5 ½" x 84" Fabric C strip on (1) side of the Center Block and pin in place. Start sewing the strip a ¼" from the top edge of the block and stop a ¼" from the bottom edge. **DO NOT TRIM THE EXCESS.** Repeat with the opposite side.

21. Repeat Step 20 to sew (1) 5 ½" x 66" Fabric C strip to the top and to the bottom of the Center Block, making sure to stop and start ¼" away from each end of the block. To miter each corner, fold the Center Block on a diagonal, wrong side together. This should line up the strips from adjacent sides (Fig. 13).

22. Starting at the sewn seam (represented by the arrow in Figure 13), draw a 45-degree line to the edge of the fabric. Sew on the drawn line. Trim the excess fabric leaving a ¼” seam. Repeat this step with the remaining corners to make the quilt top.

23. Layer and quilt as desired.

24. Sew the (8) 2 1/2" x WOF Fabric I strips together, end to end with 45-degree seams, to make the binding. Fold this long strip in half lengthwise with wrong sides together and press.

25. Bind as desired.

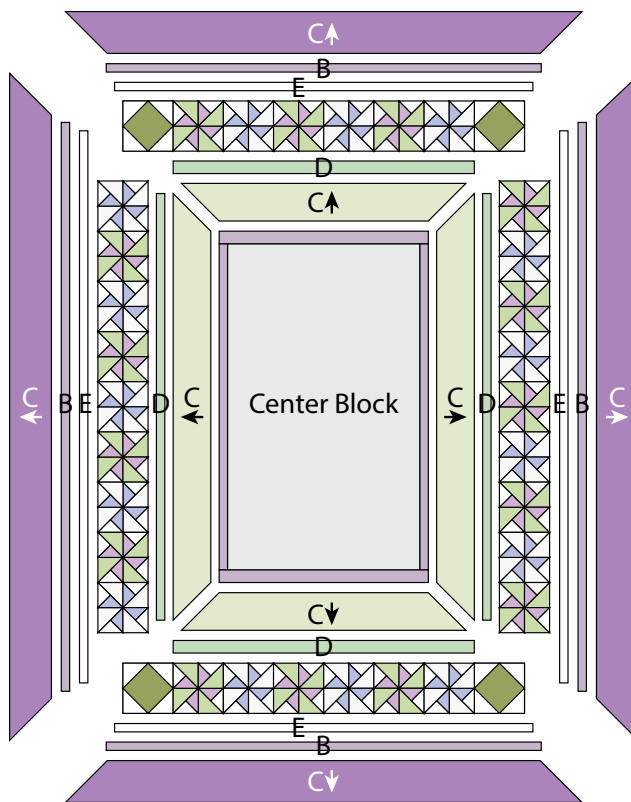

## Quilt Layout

*Every effort has been made to ensure that all projects are error free. All the information is presented in good faith, however no warranty can be given nor results guaranteed as we have no control over the execution of instructions. Therefore, we assume no responsibility for the use of this information or damages that may occur as a result. When errors are brought to our attention, we make every effort to correct and post a revision as soon as possible. Please make sure to check [www.henryglassfabrics.net](http://www.henryglassfabrics.net) for pattern updates prior to starting the project. We also recommend that you test the project prior to cutting for kits. Finally, all free projects are intended to remain free to you and are **not for resale**.*